

## Installation Instructions- 2" Fault Warning Alarm Gauge (FWA) Model # VJSFWA + colors

### PLEASE READ THE COMPLETE INSTRUCTIONS BEFORE ATTEMPTING TO INSTALL GAUGE.

This FWA gauge is needed in order for Vantage View to receive Faults and Alarms from Cummins Diesel engines, *if* a Diesel View display is not present. The FWA gauge will work on all engine protocols except for SMARTCRAFT Mercury gasoline engines.

This gauge provides five discrete illuminated visual indicators and multiple outputs. Outputs include a dedicated audible alarm and one set of relay output contacts for secondary alarms or additional engine protection devices.

#### WARNING:

Improper installation may damage the instrument and/or cause injury to the installer. If you have installation questions, please contact the Livorsi. Disconnect battery cables before installing the instrument. Check for obstructions behind dash panel such as wires and hoses before cutting the mounting hole for the instrument.

#### INSTALLATION:

**Cutout:** Recommended dash hole size: 2.125±.015 in (53.98±0.38 mm) diameter. Secure the instrument into dashboard with mounting "J" clamps and keps nuts. Maximum recommended tightening torque for all hardware: 6 lb-in (0.68 N-m). Caution, over tightening mounting hardware may damage the instrument. Position instrument in dash board prior to tightening clamp nuts to recommended torque.

#### WIRING:

This FWA gauge **must** be installed using the last deutsch connector at the end of the VV slave harness. Installing this gauge on any other connector will not work, and may damage the gauge. **Relay contact output:** Connected between pins 4 and 5 is a relay contact that will close upon alarm. This contact is rated 1A. Permanent damage will occur if a current load in excess of 1A is switched through pins 4 and 5.

**Piezo tweeter current sink:** Pin 6 is a current sink to ground. It is capable of sinking 150mA (.15A) at 12V. Permanent damage will occur if a load in excess of 150mA is attached.

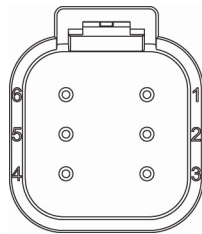

| 6 Pin Connector Wiring Table |                      |            |
|------------------------------|----------------------|------------|
| Pin Number                   | Name                 | Wire Color |
| 1                            | Battery +            | Violet     |
| 2                            | Ground               | Black      |
| 3                            | Serial Data          | Gray       |
| 4                            | Relay Normally Open  | Green      |
| 5                            | Relay Common         | Black      |
| 6                            | Audible Alarm Output | Yellow     |



# Vantage View® Fault, Warning & Alarm (FWA) Gauge

715 Center Street  
 Grayslake IL 60030  
 P: 847.752.2700  
 F: 847.752.2415  
 E: info@lvorsi.com  
 www.lvorsi.com

## ⚠ WARNING

Improper installation may damage the instrument and/or cause injury to the installer. If you have installation questions, please contact the factory. Disconnect battery cables before installing the instrument. Check for obstructions behind dash panel such as wires and hoses before cutting the mounting hole for the instrument.

## DESCRIPTION

This Vantage View® instrument provides five discrete illuminated visual indicators and multiple outputs. Outputs include a dedicated audible alarm and one set of relay output contacts for secondary alarms or additional engine protection devices.

## MOUNTING

Recommended dash hole size: 2.125±.015 in (53.98±0.38 mm) DIA. Secure the instrument into dashboard with mounting "J" clamp and Kep nuts. If dashboard thickness exceeds clamp grip range, clamp legs may be shortened. Position instrument in dash board prior to tightening clamp nuts to recommended torque. Maximum recommended tightening torque for all hardware: 6 lb-in (0.68 N-m). Caution, over tightening mounting hardware may damage the instrument.

## MAINTENANCE

Periodically check and torque all hardware per mounting specifications.  
 Clean glass with a soft, damp, clean cloth.

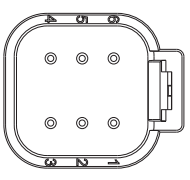
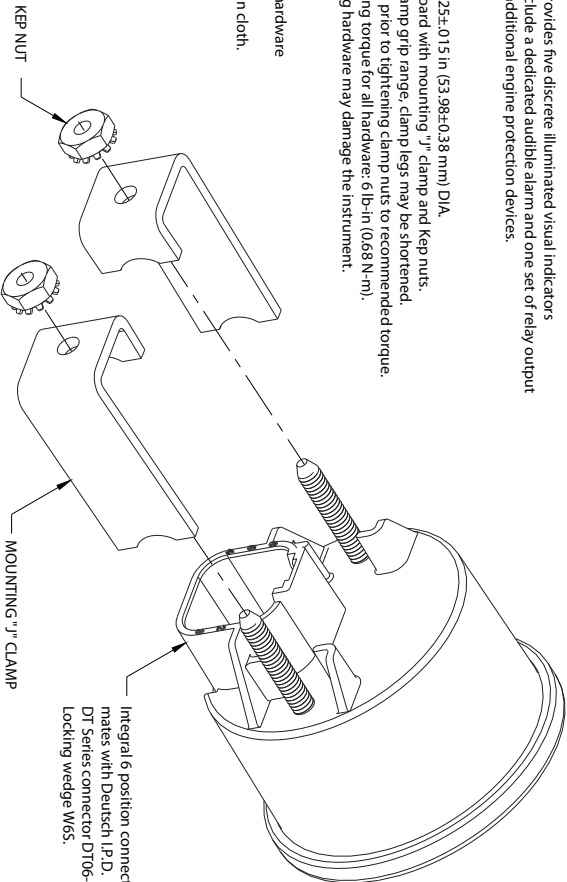

| Pin Number | Connection Name      |
|------------|----------------------|
| 1          | Battery +            |
| 2          | Ground               |
| 3          | Serial Data          |
| 4          | Relay Normally Open  |
| 5          | Relay Common         |
| 6          | Audible Alarm Output |

